

MNPV3 Procedure

May 30, 2011

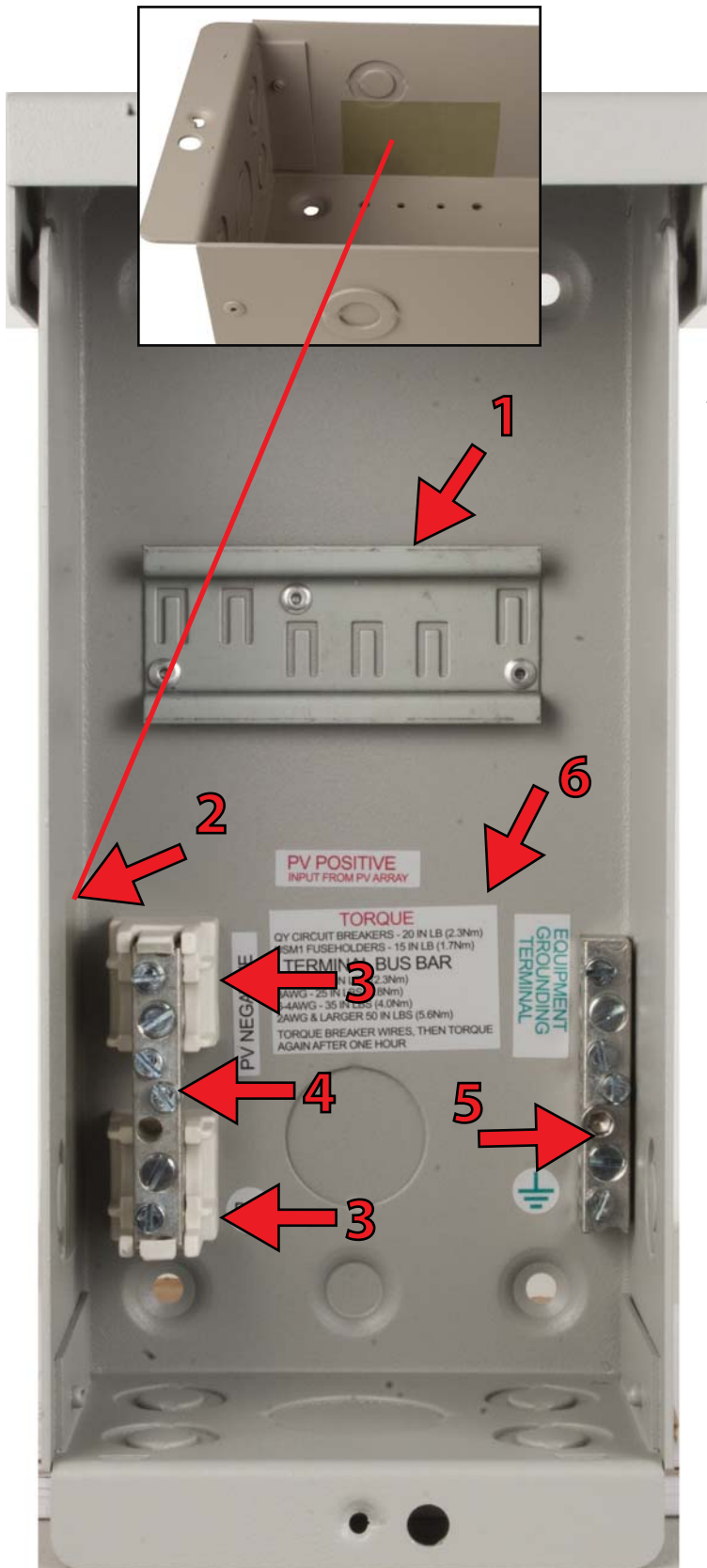

Pan head screw 10 x 3/8
#6-007-1



10-32 Lock nut
#6-016-1

Pan head screw
10-32 x 3/8
#6-036-1

Socket head cap screw
10-32 x 7/8 #6-034-1

Lock washer
#6-017-1

Step 1.
Rivet dinrail #3-074-1 to chassis
#3-071-1 using 6-049-1 rivets.

Step 2.
Apply two inch long plastic tape
to the left side wall.

Step 3.
Attach 2 white busbar insulators
#5-015-2 to the chassis with
#6-036-1 screws. Aluminum
chassis strips easily. Don't over
tighten.

Step 4.
Attach left busbar #9-037-1 to
busbar insulators.

Step 5.
Attach right side busbar #9-
037-1 using 6-034-1 screw and
lock nut #6-016-1.

Step 6.
Apply inside labels #10-008-1 to
box.

Step 7.
Apply outside labels #10-008-1 making sure that the round labels cover the plugs on both sides of the chassis.

MNPV3 MNPV6
 MNPV12 MNPV16
 -250 _____

- 600VDC WHEN USED WITH USM1 FUSE HOLDERS
- 150 OR 300VDC WHEN USED WITH MIDNITE BRKRS
- NOTE: MIDNITE SOLAR MNEPV BREAKERS ARE ETL LISTED FOR 150 OR 300 VDC OPERATION
- MAXIMUM CONTINUOUS CURRENT:
 MNPV6 = 120 AMPS, MNPV3 = 60 AMPS
 MNPV12-250 = 168 AMPS, MNPV12 = 200 AMPS
 MNPV16-250 = 240 AMPS, MNPV16 = 240 AMPS
- THIS ENCLOSURE IS INTENDED FOR DC ONLY
- MOUNTING: TILTED BACK TO 22.5° - 90° VERTICAL
- MAX SHORT CIRCUIT CURRENT RATINGS:
 10,000 AIC FOR FERRAZ ATM 600V FUSES
 10,000 AIC FOR MIDNITE MNEPV CBI QY BREAKERS

CAUTION FOR CONTINUED PROTECTION AGAINST RISK OF FIRE, REPLACE ONLY WITH SAME TYPE AND RATING OF FUSE. ADDITIONAL OR REPLACEMENT DEVICES SHALL BE OF THE SAME MANUFACTURER, TYPE DESIGNATION AND EQUAL OR GREATER INTERRUPT RATING. APPROVED FUSE IS KLM SERIES, 600VDC 30A MAX THE SHORT CIRCUIT CURRENT RATING OF THIS DEVICE IS LIMITED TO THE LOWEST INTERRUPTING RATING OF ANY INSTALLED CIRCUIT BREAKER OR FUSED SWITCH, OR COMBINATION SERIES CONNECTED CIRCUIT BREAKER.

RISK OF ELECTRIC SHOCK. DO NOT REMOVE COVER. NO USER SERVICEABLE PARTS INSIDE. REFER SERVICING TO QUALIFIED SERVICE PERSONNEL.

- USE COPPER WIRE ONLY RATED FOR 75°
- ENCLOSURE TYPE 3R RAINPROOF

Conforms to UL Std. 1741
 1ST Edition May 7, 1999
 Revised 11/07/05
 Conforms to UL Std. 67
 11th Edition Dec 8, 1993
 Revised 4/12/2006
 Cert. to CAN/CSA
 Std. C22.2
 No. 29-M1989

MANUFACTURE DATE
 Q1 Q2 Q3 Q4
 09 10 11 12 13

MidNite SOLAR, Inc.
 1722 67TH AVE NE
 ARLINGTON, WA
 MADE IN USA

The side label needs to have the model number checked, in this case, MNPV3, which quarter of the year, in this case, the second quarter (Q2) and the last two digits of the year the unit was assembled, (11).

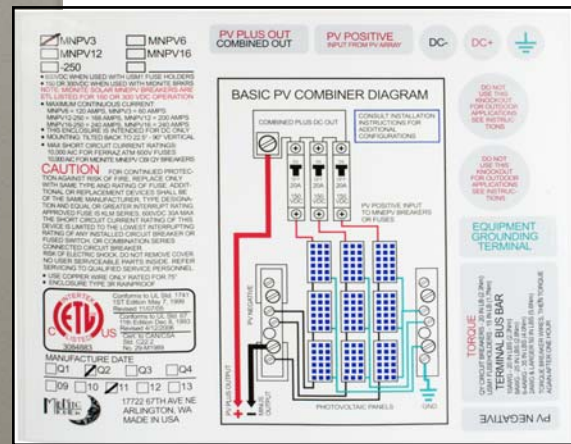

Labels #10-008-1



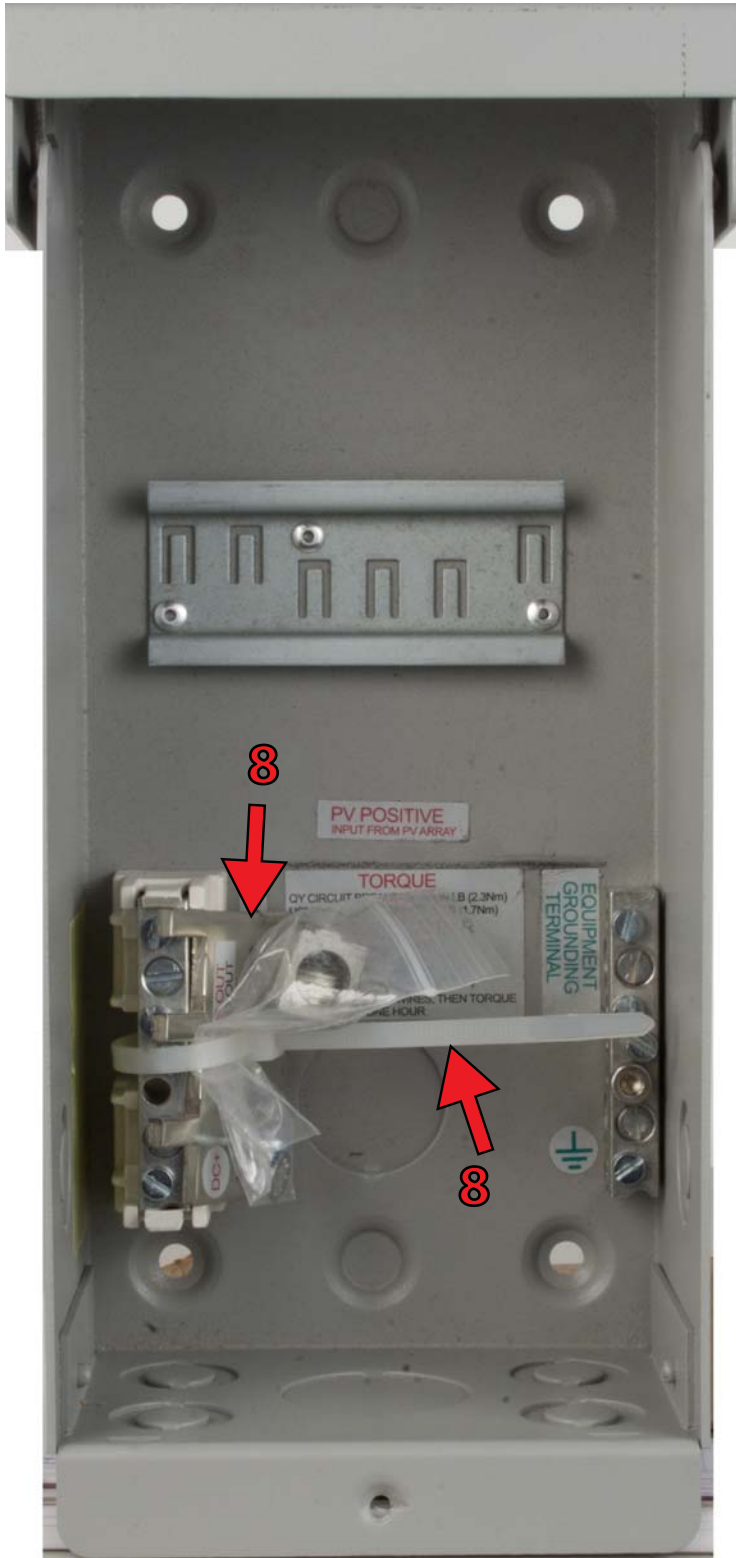

Step 8.
 Attach plastic hardware bag #9-111-1 and busbar #3-073-2 with a short wire tie #6-014-1.

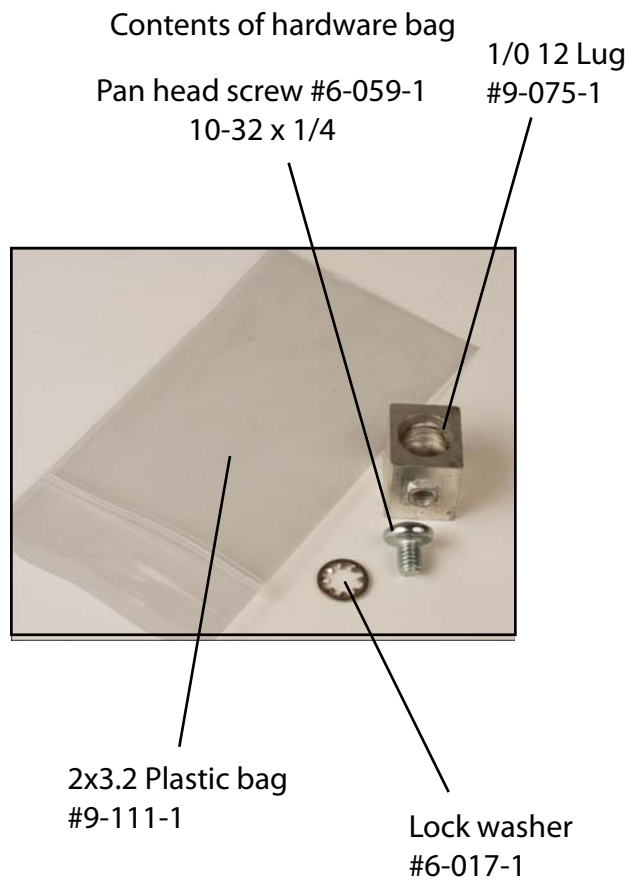

Step 9.
Wedge the foam wrapped hardware #5-040-1 inside the chassis so that it won't rattle around.

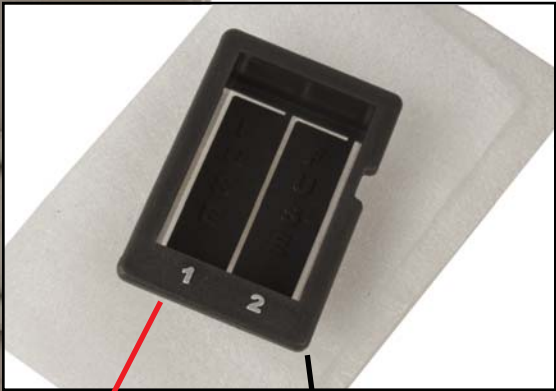
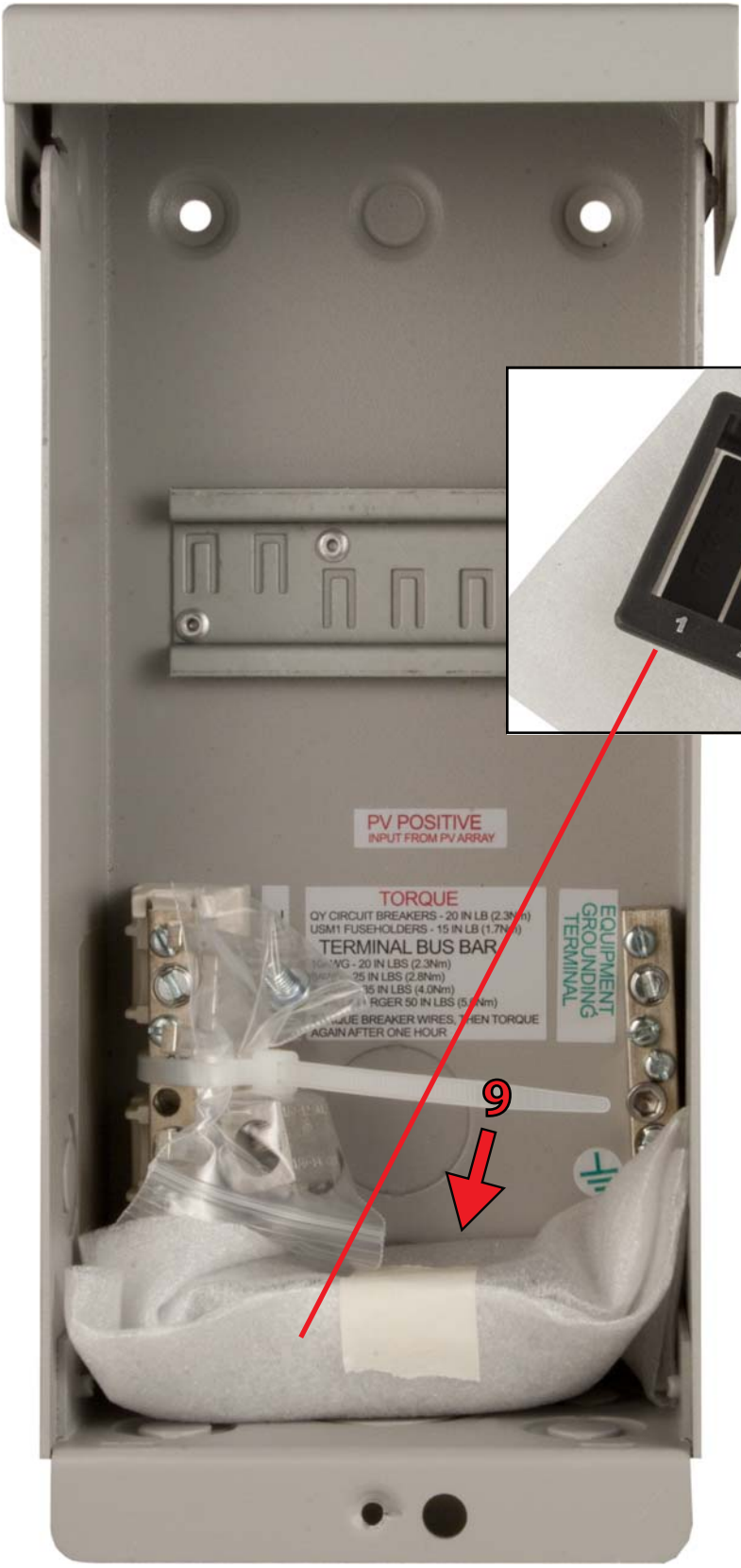

PV3 Fuse Adapter #5-040-1

PV POSITIVE
INPUT FROM PV ARRAY

TORQUE
QY CIRCUIT BREAKERS - 20 IN LBS (2.3Nm)
USM1 FUSEHOLDERS - 15 IN LB (1.7Nm)
TERMINAL BUS BAR
10mmWG - 20 IN LBS (2.3Nm)
16mmWG - 25 IN LBS (2.8Nm)
18mmWG - 35 IN LBS (4.0Nm)
1/2" RGR 50 IN LBS (5.0Nm)
TIGHTEN BREAKER WIRES, THEN TORQUE
AGAIN AFTER ONE HOUR

EQUIPMENT
GROUNDING
TERMINAL

9



Step 10.
Attach deadfront #5-020-1, sliding the bottom end in first.

Step 11.
Place note #10-008-1 so that it can be screwed down with cover screw #6-007-1 and lock washer #6-017-1.

Note #10-012-1

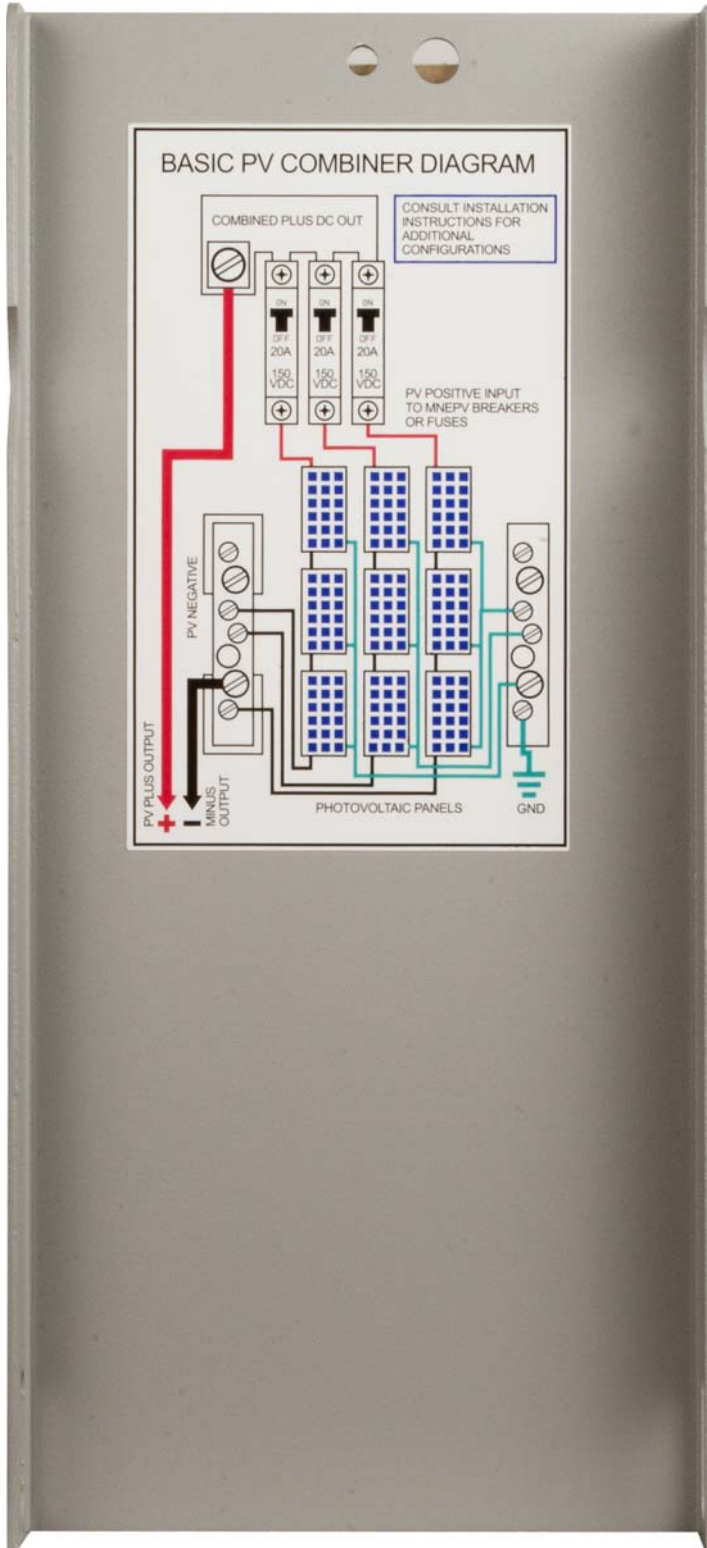

Step 12.

Attach the label to the inside of the cover #3-072-1. This label is on the label sheet #10-008-1. Place the sticker so that when the user opens the cover, the sticker is right side up.

Step 13.

Attach the cover snapping the upper end first.

Step 14.

Attach the MidNite badge #5-029-1 to the lower right cover.

Step 15.

Screw the cover down with a #6-007-1 screw and a #6-017-1 washer. Make sure the note is under the cover with the screw going through it.



Box #9-104-1



Step 16.

Use box 9-104-1. It will have MNPV3 either on the side or end of the box. Fold the two end flaps down. Then fold the side flap with no graphics and place glue as shown above. Fold the remaining flap down and press it firmly for a few seconds to allow the glue to harden.



Manual #10-010-1

Step 17.
Place the left over label sheet #10-008-1 inside the manual #10-010-1 and place the manual in the box as shown.

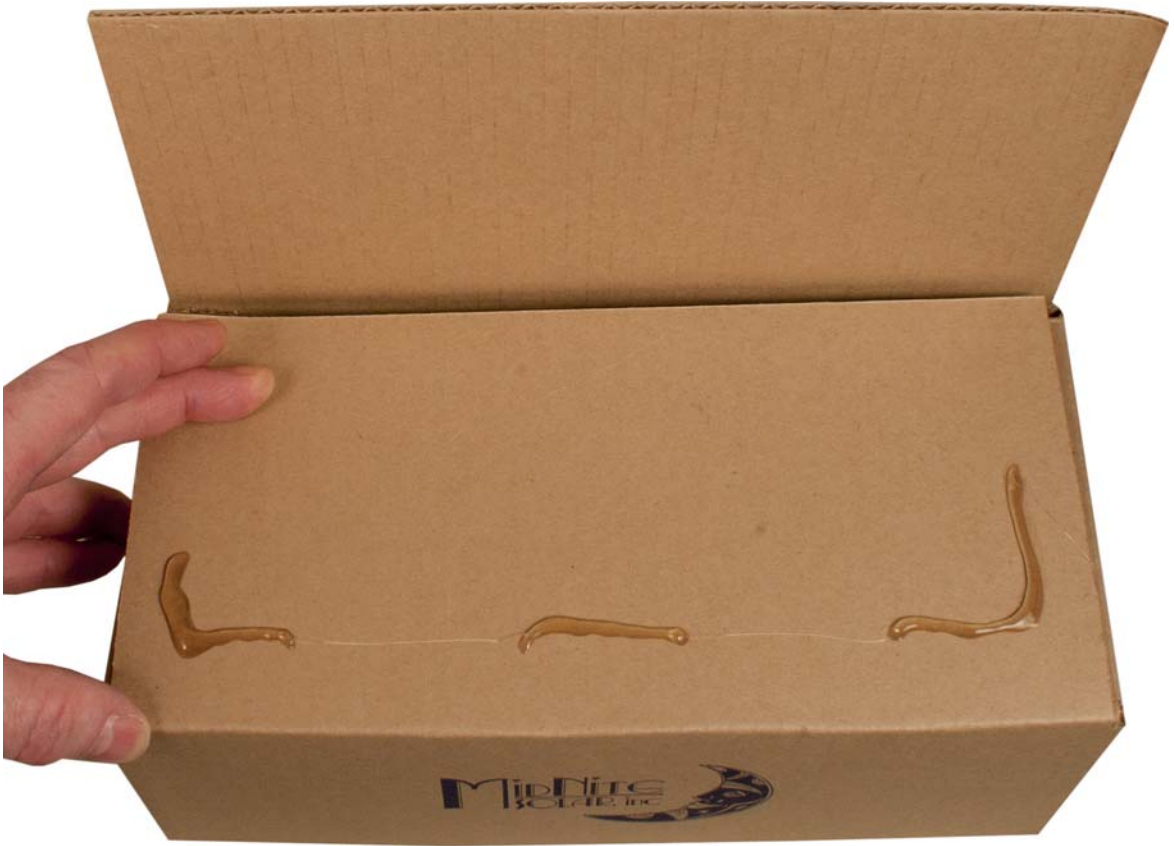

Step 18.

Glue the top of the box closed. Fold the two end flaps down. Then fold a side flap and place glue as shown above. Fold the remaining flap down and press it firmly for a few seconds to allow the glue to harden.